

# INFRASTRUCTURE PLAN FOR FLEET ELECTRIFICATION

CONCEPT DESIGN  
CITY OF RENO, NEVADA  
&  
WASHOE COUNTY, NEVADA  
*NOT FOR CONSTRUCTION*  
INCLUDED FACILITIES KEY MAP

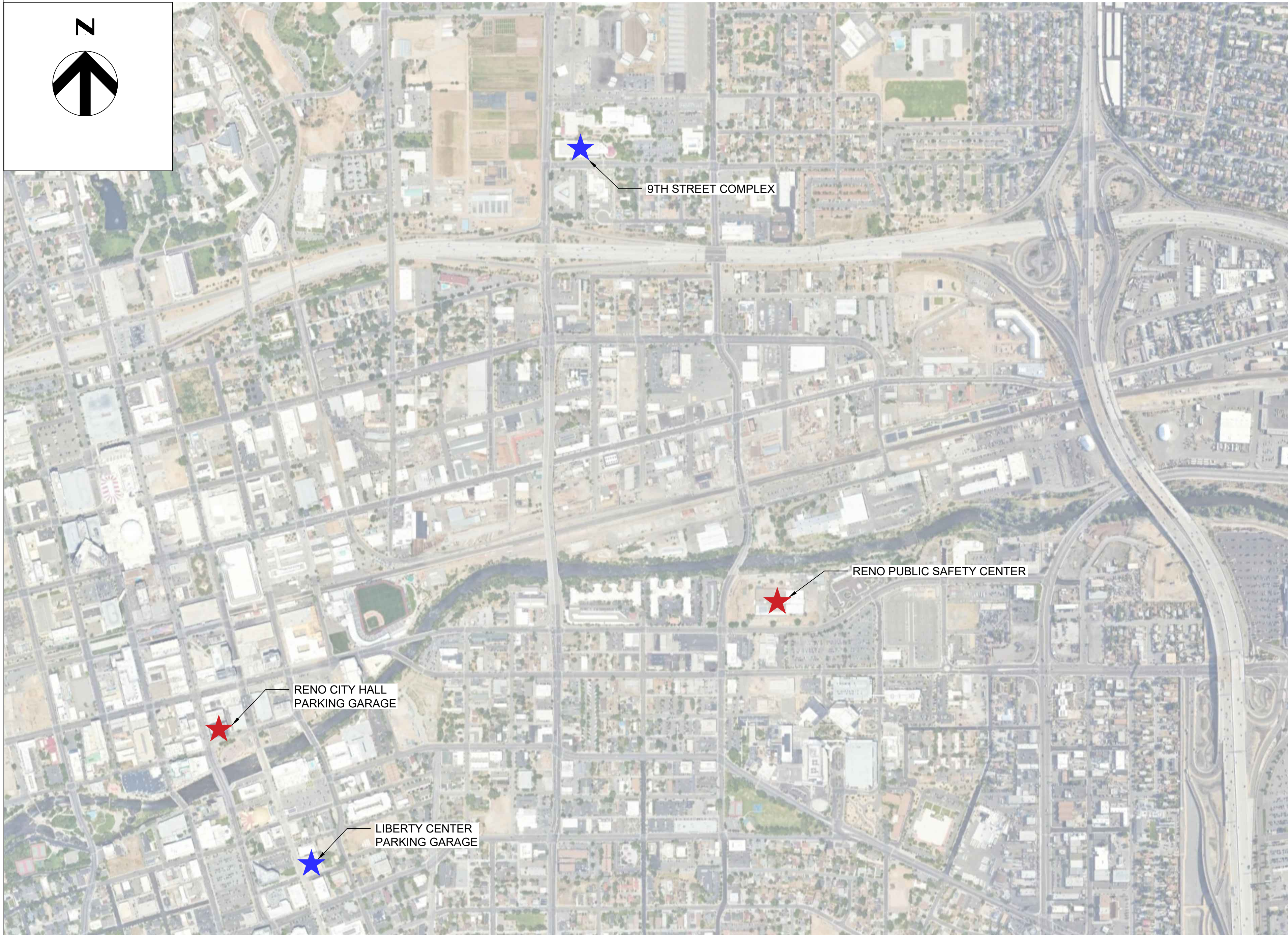

SHEET SCHEDULE

G001	OVERALL SITE PLAN
EV100	RENO CITY HALL PARKING GARAGE CONCEPT LAYOUT
EV101	RENO CITY HALL PARKING GARAGE ONE-LINE DIAGRAM
EV102	RENO PUBLIC SAFETY CENTER CONCEPT LAYOUT
EV103	RENO PUBLIC SAFETY CENTER ONE-LINE DIAGRAM
EV104	9TH STREET COMPLEX CONCEPT LAYOUT
EV105	9TH STREET COMPLEX ONE-LINE DIAGRAM
EV106	LIBERTY CENTER PARKING GARAGE CONCEPT LAYOUT
EV107	LIBERTY CENTER PARKING GARAGE ONE-LINE DIAGRAM

LEGEND

	CITY OF RENO SITE
	WASHOE COUNTY SITE

G001 OVERALL SITE PLAN  
1" = 500'

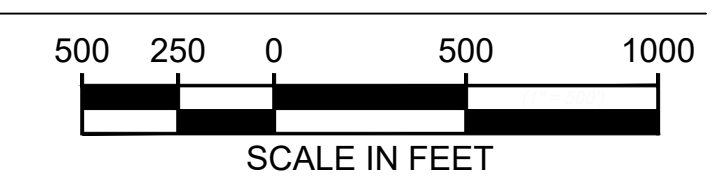

PROFESSIONAL SEAL  
NOT FOR CONSTRUCTION

NO.	REVISIONS	DATE	BY

CITY OF RENO  
1 E. FIRST STREET  
RENO, NV 89505  
755-334-4636

WASHOE COUNTY  
1001 E. NINTH STREET  
RENO, NV 89512  
775-328-2003

HDR Engineering, Inc.  
10615 Professional Circle  
Suite 200  
Reno, NV 89521-5873

INFRASTRUCTURE PLAN  
FOR FLEET ELECTRIFICATION  
CONCEPT DESIGN

OVERALL SITE PLAN

DATE	2/27/2026		
DRAWN BY	BJP	CHECKED BY	AAG
SHEET NUMBER	G001		
SHEET	1	OF	9

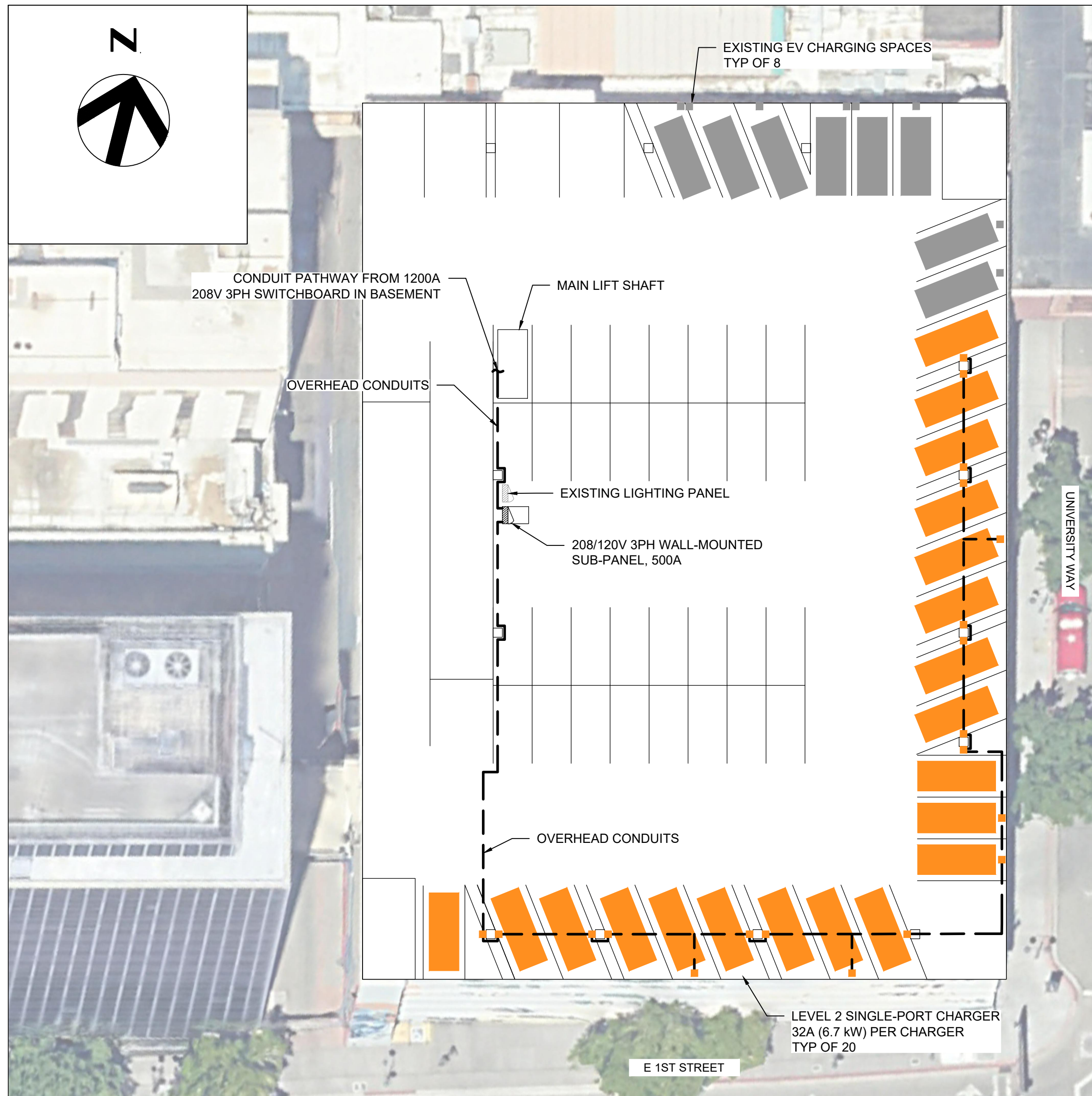

**LEGEND**

LEVEL 2 CHARGING SPACE  
 EXISTING CHARGING SPACE

**NOTES**

- BOLLARDS ARE NOT SHOWN DUE TO SCALE. TWO BOLLARDS PER WALL-MOUNTED CHARGER ARE PLANNED FOR.
- SEE ONE-LINE DIAGRAM (E-101) FOR ELECTRICAL DETAILS.

PROFESSIONAL SEAL

**NOT FOR CONSTRUCTION**

NO.	REVISIONS	DATE	BY

  
 CITY OF RENO  
 1 E. FIRST STREET  
 RENO, NV 89505  
 755-334-4636

  
 WASHOE COUNTY  
 1001 E. NINTH STREET  
 RENO, NV 89512  
 775-328-2003

EV100 RENO CITY HALL PARKING GARAGE CONCEPT LAYOUT (5TH FLOOR)  
1" = 20'

EV100 RENO CITY HALL PARKING GARAGE CONCEPT LAYOUT (6TH FLOOR)  
1" = 20'

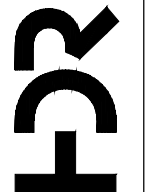

  
 HDR Engineering, Inc.  
 10615 Professional Circle  
 Suite 200  
 Reno, NV 89521-5873

INFRASTRUCTURE PLAN  
 FOR FLEET ELECTRIFICATION  
 CONCEPT DESIGN  
 RENO CITY HALL  
 PARKING GARAGE  
 CONCEPT LAYOUT

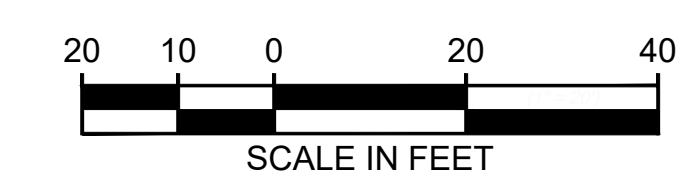
DATE	2/27/2026		
DRAWN BY	BJP	CHECKED BY	AAG
SHEET NUMBER	EV100		
SHEET	2	OF	9



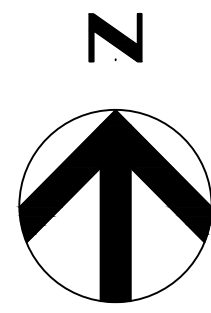



**NOTES**

1. BOLLARDS ARE NOT SHOWN DUE TO SCALE, TWO BOLLARDS PER CHARGER ARE PLANNED FOR. SEE ONE-LINE DIAGRAM (E-103) FOR ELECTRICAL DETAILS.
2. SEE ONE-LINE DIAGRAM (E-103) FOR ELECTRICAL DETAILS.

**LEGEND**

 LEVEL 2 CHARGING SPACE

25 kV:208/120V UTILITY TRANSFORMER, 225kVA  
 NV ENERGY FEEDER  
 208/120V 3PH PANELBOARD, 800A  
 LEVEL 2 SINGLE-PORT CHARGER 32A (6.7 kW) PER CHARGER TYP OF 33

EXISTING LEVEL 2 FLEET CHARGERS (4)

PROFESSIONAL SEAL

**NOT FOR CONSTRUCTION**

NO.	REVISIONS	DATE	BY

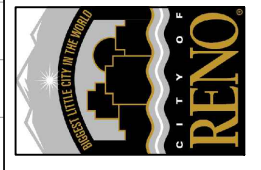

**CITY OF RENO**  
 1 E. FIRST STREET  
 RENO, NV 89505  
 755-334-4636

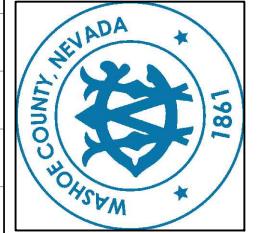

**WASHOE COUNTY**  
 1001 E. NINTH STREET  
 RENO, NV 89512  
 775-328-2003

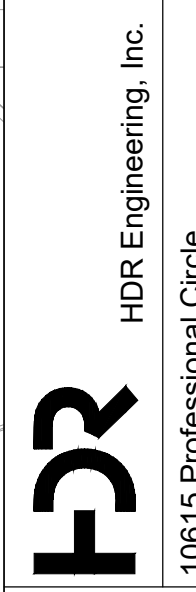

**HDR Engineering, Inc.**  
 10615 Professional Circle  
 Suite 200  
 Reno, NV 89521-5873

**INFRASTRUCTURE PLAN  
 FOR FLEET ELECTRIFICATION  
 CONCEPT DESIGN**

**RENO PUBLIC SAFETY CENTER  
 CONCEPT LAYOUT**

DATE	2/27/2026		
DRAWN BY	BJP	CHECKED BY	AAG
SHEET NUMBER	EV102		
SHEET	4	OF	9
	2:00 PM		2/26/26

**RENO PUBLIC SAFETY CENTER CONCEPT LAYOUT**

1" = 30'



EV102.dwg



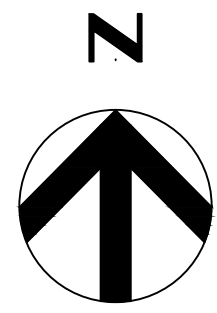

**LEGEND**

- LEVEL 2 CHARGING SPACE
- DCFC CHARGING SPACE

**NOTES**

1. BOLLARDS ARE NOT SHOWN DUE TO SCALE, TWO BOLLARDS PER CHARGER ARE PLANNED FOR.
2. SEE ONE-LINE DIAGRAM (E-105) FOR ELECTRICAL DETAILS.

PROFESSIONAL SEAL

**NOT FOR CONSTRUCTION**

NO.	REVISIONS	DATE	BY

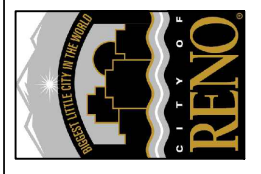

CITY OF RENO  
 1 E. FIRST STREET  
 RENO, NV 89505  
 755-334-4636



WASHOE COUNTY  
 1001 E. NINTH STREET  
 RENO, NV 89512  
 775-328-2003



HDR Engineering, Inc.  
 10615 Professional Circle  
 Suite 200  
 Reno, NV 89521-5873

INFRASTRUCTURE PLAN  
 FOR FLEET ELECTRIFICATION  
 CONCEPT DESIGN

9TH STREET COMPLEX  
 CONCEPT LAYOUT

DATE 2/27/2026

DRAWN BY BJP CHECKED BY AAG

SHEET NUMBER EV104

SHEET 6 OF 9

2:00 PM 2/26/26

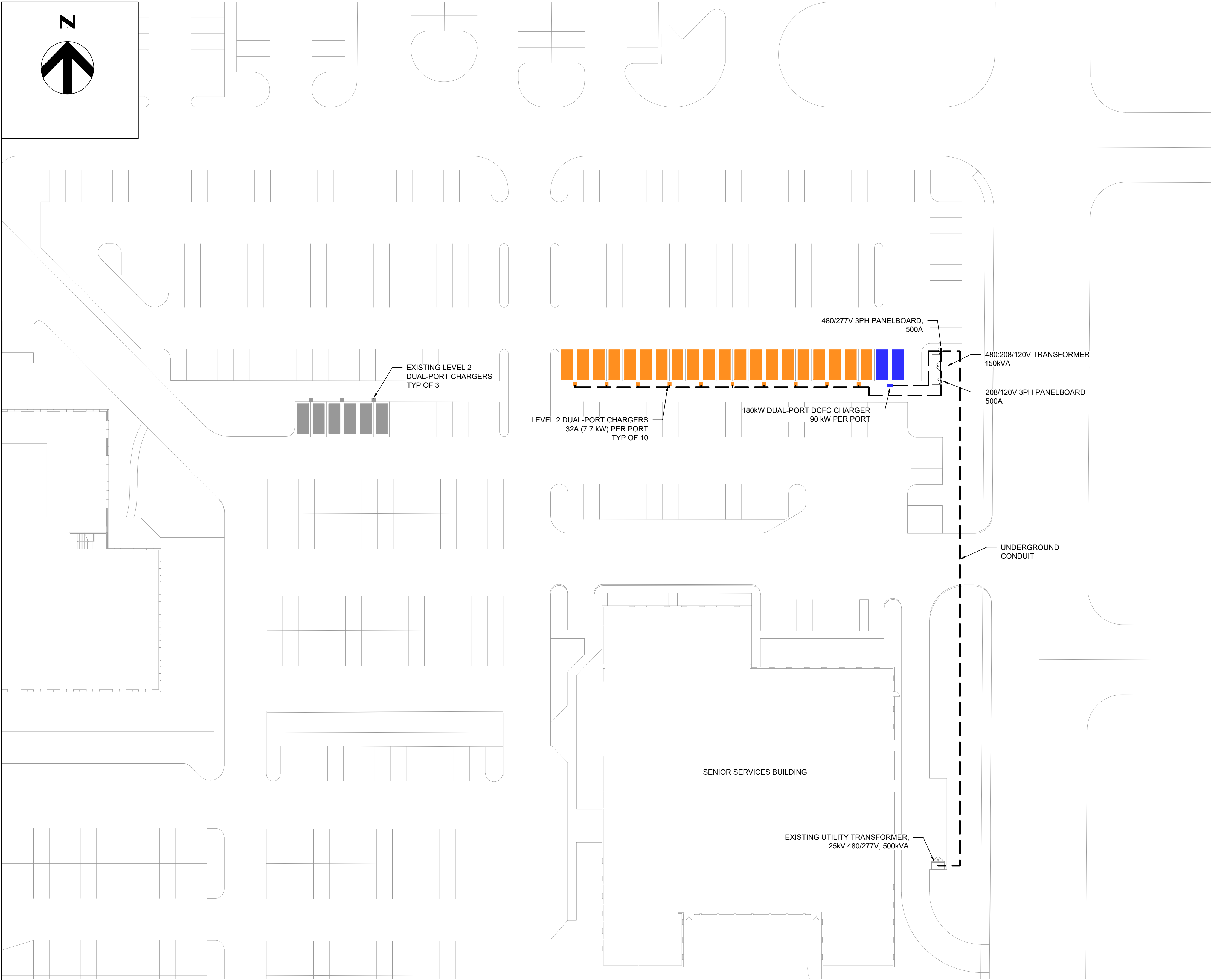

**9TH STREET COMPLEX CONCEPT LAYOUT**

EV104

1" = 30'

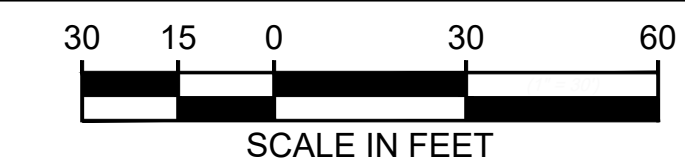

EV104.dwg



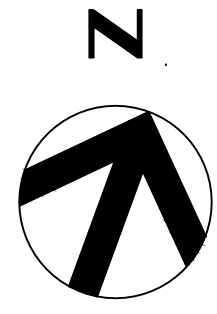

SOUTH CENTER STREET

RYLAND STREET

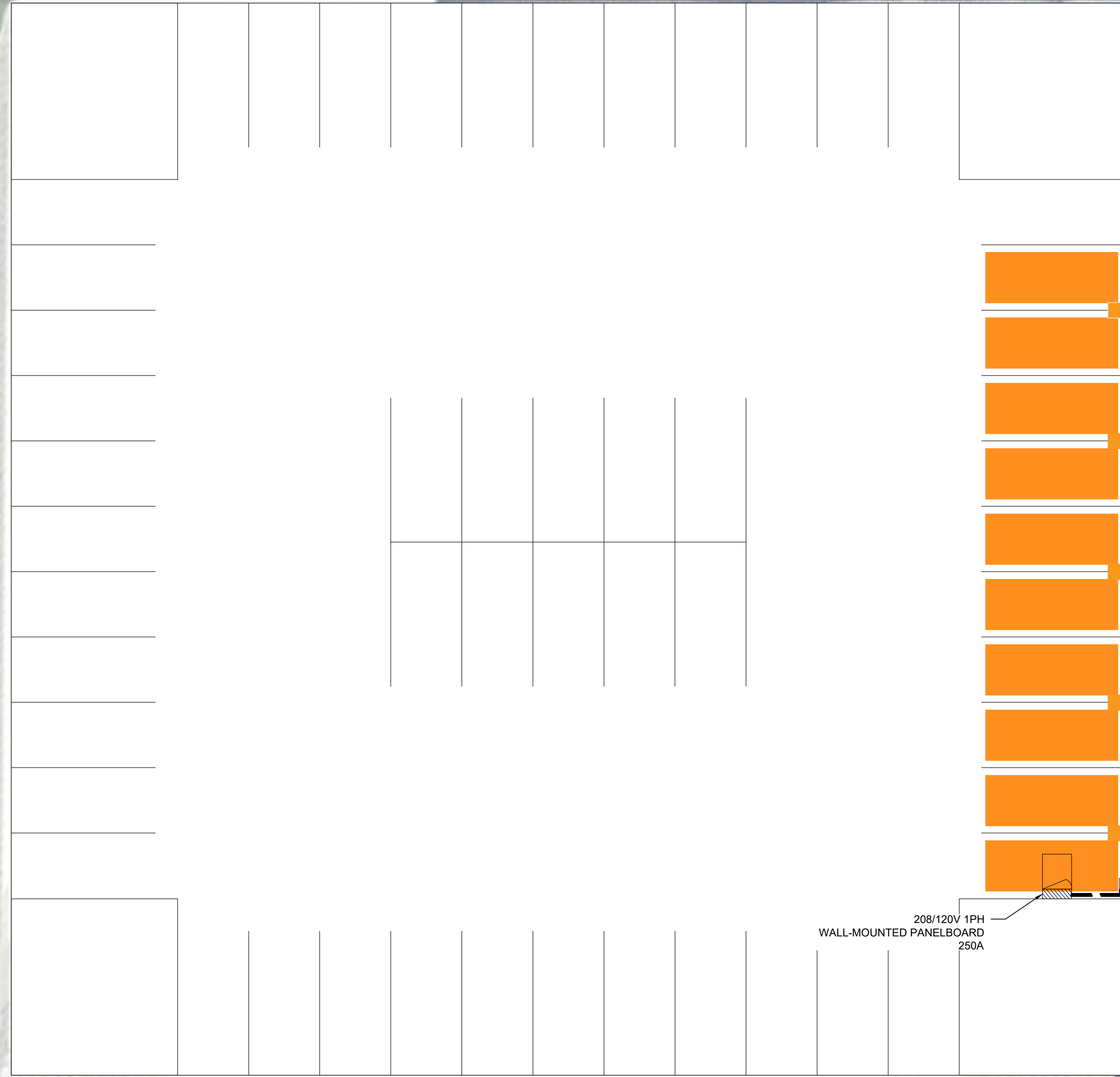

LEVEL 2 DUAL-PORT CHARGERS  
32A (6.7 kW) PER PORT  
TYP OF 5

WALL MOUNTED CONDUIT

EXISTING CONDUIT SHAFT  
ROUTED FROM ELECTRICAL ROOM

208/120V 1PH  
WALL-MOUNTED PANELBOARD  
250A

**LEGEND**

 LEVEL 2 CHARGING SPACE

**NOTES**

- 1. SEE ONE-LINE DIAGRAM (E-107) FOR ELECTRICAL DETAILS.

PROFESSIONAL SEAL

NOT FOR  
CONSTRUCTION

NO.	REVISIONS	DATE	BY

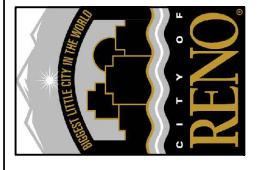

CITY OF RENO  
1 E. FIRST STREET  
RENO, NV 89505  
755-334-4636



WASHOE COUNTY  
1001 E. NINTH STREET  
RENO, NV 89512  
775-328-2003

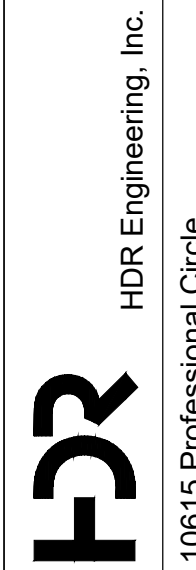

HDR Engineering, Inc.  
10615 Professional Circle  
Suite 200  
Reno, NV 89521-5873

INFRASTRUCTURE PLAN  
FOR FLEET ELECTRIFICATION  
CONCEPT DESIGN  
LIBERTY CENTER  
PARKING GARAGE  
CONCEPT LAYOUT

DATE 2/27/2026

DRAWN BY BJP CHECKED BY AAG

SHEET NUMBER EV106

SHEET 8 OF 9

2:00 PM 2/26/26

LIBERTY CENTER PARKING GARAGE CONCEPT LAYOUT (2ND FLOOR)

EV106

1" = 10'

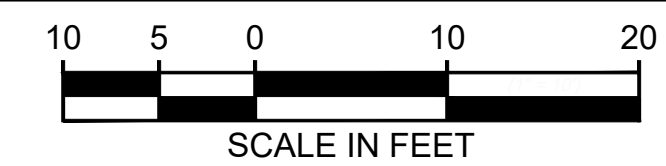

SCALE IN FEET

EV106.dwg

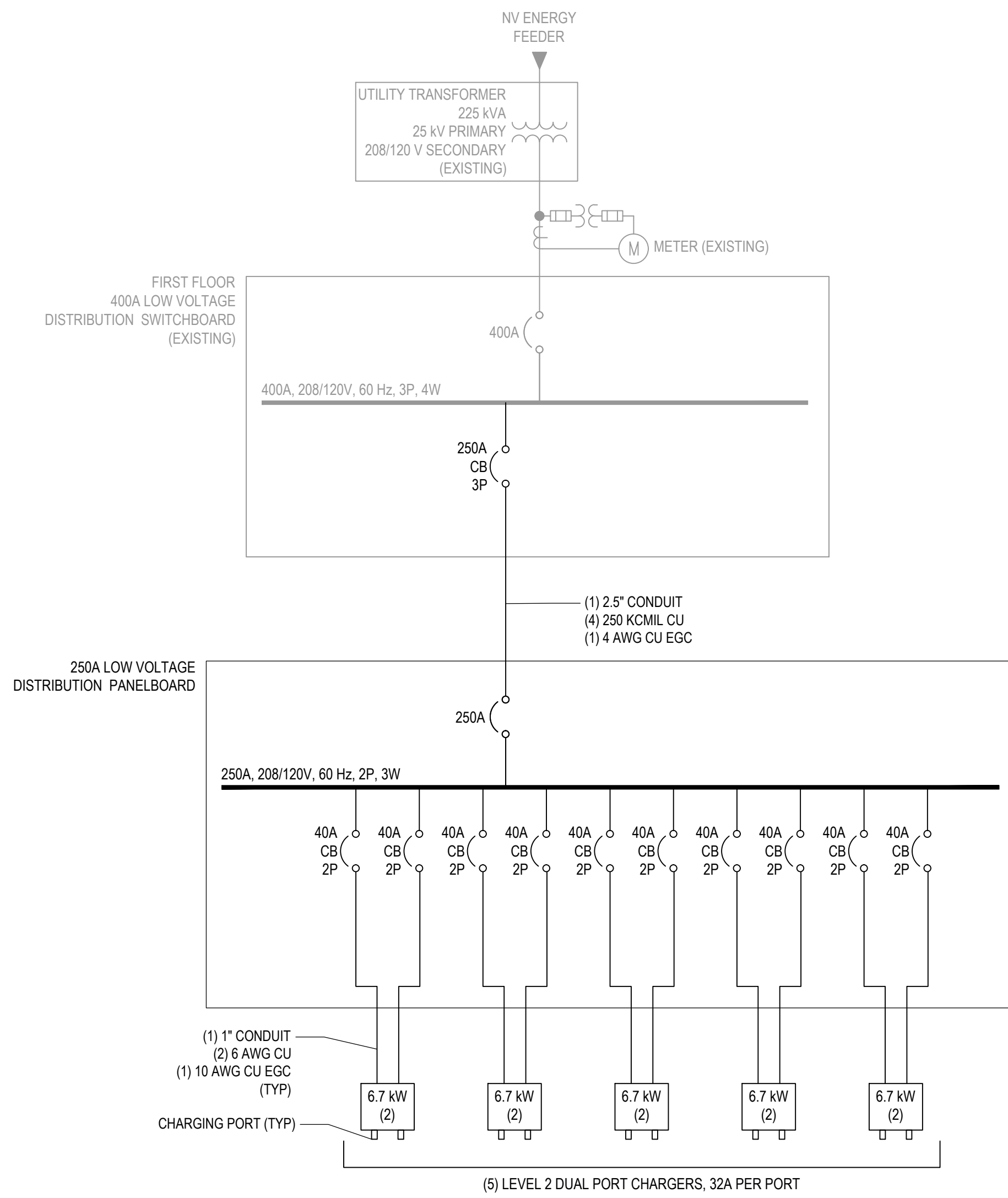

EV107 LIBERTY CENTER PARKING GARAGE ONE-LINE DIAGRAM

PROFESSIONAL SEAL

NOT FOR CONSTRUCTION

NO.	REVISIONS	DATE	BY

 CITY OF RENO  
1 E. FIRST STREET  
RENO, NV 89505  
755-334-4636

 WASHOE COUNTY  
1001 E. NINTH STREET  
RENO, NV 89512  
775-328-2003

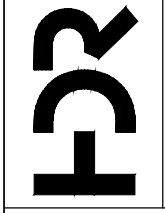
 HDR Engineering, Inc.  
10615 Professional Circle  
Suite 200  
Reno, NV 89521-5873

INFRASTRUCTURE PLAN  
FOR FLEET ELECTRIFICATION  
CONCEPT DESIGN  
LIBERTY CENTER  
PARKING GARAGE  
ONE-LINE DIAGRAM

DATE	2/27/2026		
DRAWN BY	BJP	CHECKED BY	AAG
SHEET NUMBER	EV107		
SHEET	9	OF	9